

Warranty

Your new product has a warranty of 12 months from the date of consumer purchase. Please keep your receipt or order number as it will be required as proof of date of purchase. This warranty only applies if the item has been used solely for household use and all instructions have been followed properly. Abuse of your appliance will invalidate the warranty. Returned goods cannot be accepted unless repacked properly within the original colour box, and presented with the original receipt or order confirmation. This does not affect your statutory rights.



GRILL TOASTER

Model : GT-328

Wattage: 650W for toaster and 300W for grill

Rating voltage: 240V~50Hz

Please read the manual carefully before using your appliance.
Keep the manual for future reference.

IMPORTANT SAFEGUARDS

General safety instructions

1. Please read the following instructions and keep them for later reference.

2. This appliance is not intended for use by persons (including children) with limited physical, sensory or mental capacities or lacking in experience and/or knowledge, unless they are supervised by a person responsible for their safety or have received instructions from this person on how to use the appliance.

3. Children should be supervised in order to ensure that they do not play with the appliance.

4. Keep the appliance in a location which is not accessible to children.

5. This appliance may not be operated with an external timer or a remote control system.

6. Never immerse the appliance or the power cord in water or other liquids except for the removable griddle plate.

7. The appliance and the power cord may not be cleaned in the dishwasher only the removable griddle plate is dishwasher friendly.

8. The appliance may not come into contact with water or other liquids. However, if this should happen , all parts must be dried completely before it is used again.

9. The appliance is only intended for household use or for similar purposes.
10. Regularly check the appliance, the plug and the supply cable for wear or damage.

11. In order to prevent damage, the appliance may not be used with accessories of other manufacturers or brands.

12. Pull the mains plug out of the socket after use, as well as before cleaning. Never leave the appliance unattended if the mains plug is plugged in.

13. Never open the housing of the appliance! This can provide a risk of an electric shock.

Information for the setup and operation of the appliance

14. The appliance and the power cord may not be cleaned in the dishwasher.

15. The appliance may not come into contact with water or other liquids.

16. Never touch the appliance and/or the power cord with wet hands.

17. For safety reasons, never place the appliance on hot surfaces, on a metal tray or on a wet surface.

steel wool, metal objects, hot cleansers or disinfectants, because they could cause damage.

5. In order to remove lodged bread slices, pull out the mains plug, turn over the appliance and shake it gently. Never attempt to remove a lodged piece of bread using pointed tools or cutlery.

6. The griddle can be removed for cleaning. You can clean the griddle in the dishwasher (top basket) or with water and some detergent.

7. When the griddle has dried completely, push it back into the panel until it locks into place.
8. Remove crumbs and residue from the crumb drawer on a regular basis. To do so, pull the side crumb drawer out completely and empty it. Wipe off the crumb drawer with a damp cloth, dry it off thoroughly and slide the drawer back into the appliance.

9. The appliance must be completely dry before you use it again.

10. You can wrap the cable around the cable storage on the underside of the appliance.

7. After the reheating process is completed, the bread is automatically ejected. The appliance switches off.
8. Please observe that the toasting level cannot be selected for the reheating function.
9. Remove the mains plug if you are finished with the reheating of the toast or buns.

OPERATION – DEFROSTING

With the defrosting function the bread is first defrosted and then toasted. Therefore, the process lasts somewhat longer than the normal toasting process.

1. Insert the bread slices into the slots of the toasting chamber.
2. Press the toast lever down until it locks in place.
3. Choose the desired toast setting.
4. We recommend the following toast settings:
 - Low for bread from the refrigerator and/or thin frozen bread slices
 - Medium for frozen waffles, buns
 - High for thicker frozen bread slices as well as buns and thick slices of toast.
5. Press the toast lever down until it locks in place.
6. Then press the “Defrost” button.
7. Toast and buns are defrosted and toasted.
8. You can interrupt the process at any time by pressing the “Cancel” button.
9. After the defrosting process is completed, the bread is automatically ejected.
10. Pull out the mains plug if you are finished with the defrosting of toast, bread or buns.

OPERATION – COOKING ON THE GRIDDLE

You can prepare foods such as eggs and bacon on the griddle.

1. Fold out the griddle.
2. Make any necessary preparations for the food to be cooked and keep it ready.
3. Switch the ON/OFF switch to “ON”.
4. Place your food on the griddle and turn it multiple times while cooking, until it is done.
5. Do not use any metal tools to turn or remove the food, because they can damage the griddle. Wooden tools are best suited for this purpose.
6. In order to prevent the overheating of the appliance, please do not cover the griddle with aluminum foil or other objects.
7. Do not touch the griddle while the appliance is in operation, because there is a risk of burns. The griddle remains hot for some time after the cooking.
8. Switch off the appliance by switching the ON/OFF switch to “OFF” and pull out the mains plug.
9. Once the griddle has cooled down and is clean, you can close it again. For this purpose, push the panel closed until it audibly clicks into place.

Removing and inserting the griddle

10. For this purpose, press the button on the left side of the panel. The griddle pops up and can be removed.
11. To insert the griddle, place it on the panel and push it down until it locks into place. In the process, please note that the mount on the rear side of the griddle must face left towards the locking button.

CLEANING AND CARE

1. **Let the appliance cool down before you clean it.**
2. **Always switch off the appliance before cleaning and pull the plug out of the outlet.**
3. The appliance and the supply cable may not be immersed in water or any other liquid or cleaned in the dishwasher.
4. Wipe off the toaster with a damp cloth and some detergent. Never use harsh abrasives,

18. The appliance and power cord may not be operated in the vicinity of flames.
19. Always use the appliance on a clear, level and heat-resistant surface.
20. Make sure that the power cord does not hang over the edge of the work surface, because this could lead to accidents, e.g. from small children pulling on it.
21. Never wrap the power cord around the device; instead, use the cable storage provided for this purpose at the base of the appliance.
22. The power cord must be routed in such a way that pulling on it and tripping over it are prevented.
23. Only use the appliance indoors.
24. For safety reasons, never cover the appliance and the griddle surfaces with paper, film or other foreign objects. Otherwise there is a risk of fire!
25. In order to avoid burns, do not touch hot surfaces. Always use the handles and the control knobs.
26. Never touch the griddle surfaces with parts of your body or heat-sensitive objects either during operation or immediately after.
27. The bread may burn, therefore do not use the appliance Near or below combustible material, such as curtains..
28. In order to avoid injury, do not slide the appliance while it is in operation.
29. Never operate the appliance without the crumb drawer and remove the crumbs regularly.
30. Do not toast any foods which can melt.
31. Do not insert any oversized food, metal foil, cutlery or tools into the appliance. They could cause a fire or short-circuit.
32. Do not leave the appliance unattended as long as it is hot as it presents a risk of fire!
33. Let the appliance cool down before folding in the griddle and stow the appliance for later use.



Caution:

The appliance becomes hot during operation!

TIPS FOR IDEAL TOASTING RESULTS

1. Different types of bread have varying moisture content. Therefore, the same toast darkness setting can produce different results.
2. For bread that is slightly dry, use a lower toast darkness setting.
3. For fresh bread or whole grain bread, use a higher toast darkness setting.
4. Bread with an irregular surface requires a higher toast darkness setting.
5. Thick bread slices need more time for - toasting; it may even be necessary to toast the bread a second time.
6. When toasting raisin bread, remove all raisins from the surface, since otherwise they could burn.
7. Cut rolls in half before toasting.
8. If you toast only one slice, please select a low toast darkness setting.
9. If you toast several slices one after the other, the bread will be somewhat darker when using the same toast darkness setting.
10. To toast frozen bread, waffles, etc. please use the defrost button.
11. To warm rolls, please use the bun warmer.

INDIVIDUAL PARTS

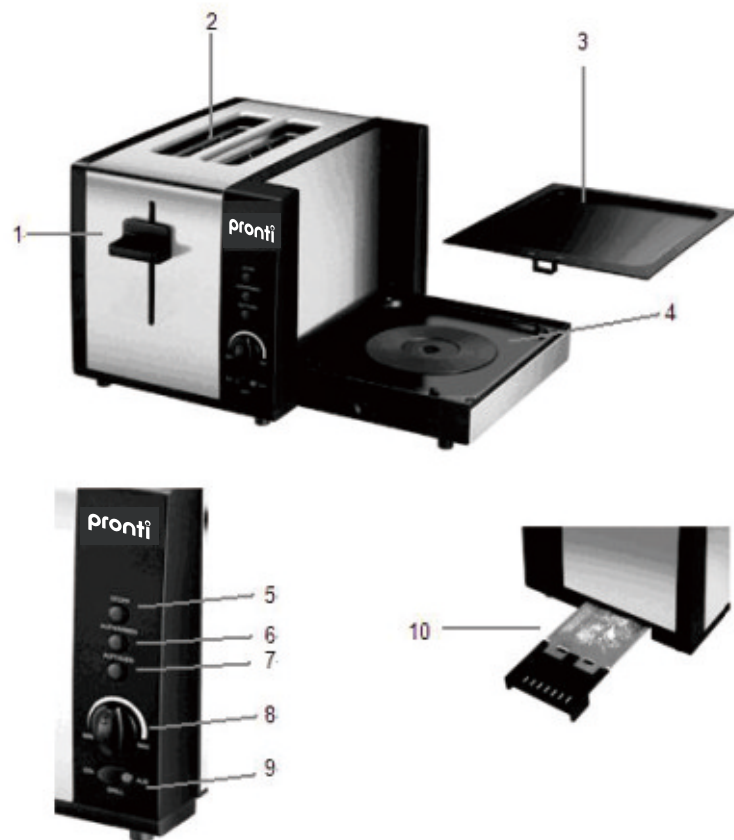

1 Toast lever

2 Bread slots

3 Removable griddle

4 Panel for griddle

5 Cancel button

6 Reheat button

7 Defrost button

8 Toast setting

9 ON/OFF switch for griddle

10 Crumb drawer

BEFORE USING FOR THE FIRST TIME

1. Remove all packaging materials and transport locks, if applicable.
2. Check whether all listed accessory parts are present
3. Clean the toaster with a damp cloth as described in the chapter "Cleaning and care" on page 5.
4. Wipe the folding griddle with a damp cloth and dry it carefully.
5. Check whether all parts are properly assembled and the appliance is stable.
6. Make sure that there is sufficient clearance from walls and other appliances, because the toaster becomes hot during operation.
7. Plug in the power cord.
8. Before toasting for the first time, one toasting cycle must be performed without bread. For this purpose, press the toast lever down until it locks in place.
9. When the toasting process is complete the toast lever automatically pops up. Now you can begin toasting bread.
10. Similarly, the griddle should be heated up once before its initial use.
11. Fold out the griddle.
12. Switch the ON/OFF switch to "ON". The preheating begins.
13. Heat up the appliance for a few minutes without food in order to remove any residue from the manufacturing process. Open the window during this burn-in phase.
14. Any already existing signs of use can be seen on the griddle after the burn-in, however they do not inhibit the function of the appliance and are not grounds for complaint.
15. Before using the griddle for the first time, lightly grease it with a brush with a heat resistant greasing product, such as margarine (Since the griddle of the appliance is coated, you need only grease it before the initial use).
16. If a mild odour becomes perceptible after heating up your new appliance for the first time, it is completely harmless.
17. Please observe that the griddle can become very hot during the heating process - risk of burning!

OPERATION – TOASTING

1. Prepare the toaster as described under "Before using for the first time".
2. Insert the bread slices into the slots of the toasting chamber.
3. Set the desired toast darkness with the darkness control. For golden brown toast set the lever in the middle position. Press the toast lever down until it locks in place.
4. The toasting process begins.
5. You can interrupt the toasting process at any time by pressing the "Cancel" button.
6. Once your desired toasting level is reached, the bread is automatically ejected. The appliance switches off.
7. In order to make removal of the toasted bread slices easier, the toaster has a lift function. For this purpose, push the toast lever up slightly when you want to remove the toast.
8. Pull out the mains plug when you are finished preparing the toast.

OPERATION – REHEATING

With the reheat function you can reheat bread or buns without toasting them.

1. Insert the bread slices into the slots of the toasting chamber.
2. If you would like to warm up buns, place the bun attachment on the toaster and place the buns on top.
3. Press the toast lever down until it locks in place.
4. Then press the "Reheat" button.
5. Toast and buns are reheated, but not toasted.
6. You can interrupt the reheating process at any time by pressing the "Cancel" button.